

RESOLUTION NO. 5240

**A RESOLUTION OF THE CITY COUNCIL OF THE CITY OF SOLEDAD
APPROVING A TASK ORDER FOR PROFESSIONAL SERVICES WITH YAMABE &
HORN ENGINEERING, INC., IN AN AMOUNT NOT-TO-EXCEED \$58,800 FOR CIVIL
ENGINEERING, BID SUPPORT, CONSTRUCTION MANAGEMENT AND POST
CONSTRUCTION SERVICES FOR THE DESIGN AND CONSTRUCTION OF THE
FRONT AND EAST STREET INTERSECTION TRAFFIC SIGNAL PROJECT**

WHEREAS, in order to facilitate recent residential development in the City in an orderly manner, in accordance with one of the adopted CEQA mitigation measures set forth in the Miravale II EIR, the City must provide traffic control at the intersection of Front Street and East Street; and

WHEREAS, upon completion of an Intersection Control Evaluation (ICE) study of the intersection, it was determined that the appropriate traffic control is a fully signalized intersection; and

WHEREAS, on November 5, 2014, Council authorized a two year agreement extension with Yamabe & Horn Engineering for on-call engineering services such as this project; and

WHEREAS, Staff requested a proposal from Yamabe and Horn to provide engineering services for this project; and

WHEREAS, the total anticipated cost of requisite professional services is \$58,800 as outlined in the attached Yamabe and Horn Proposal; and

WHEREAS, funding for this project is available in the adopted Fiscal Year 2016-2017 Budget for Transportation Impact Fee Funds; and

WHEREAS, after reviewing the Yamabe and Horn proposal, staff has determined that it is reasonable, and therefore Staff is recommending that Council award this Front Street and East Street Intersection Traffic Signal Project Engineering Task Order to them.

NOW THEREFORE, BE IT HEREBY RESOLVED, by the City Council of the City of Soledad that a "Task Order for Professional Services with Yamabe & Horn Engineering, Inc., to Provide Civil Engineering Design, Bid Support, Construction Management and Post Construction Services for Design and Construction Management of the Front Street and East Street Intersection Traffic Signal Project," a copy of which is attached hereto marked as **Exhibit A**, and by this reference incorporated herein, is hereby approved.

PASSED AND ADOPTED by the City Council of the City of Soledad at a regular meeting duly held on the 2nd of November, 2016, by the following vote:

AYES, and in favor thereof, Councilmembers: Patricia D. Stephens, Alejandro Chavez, Richard Perez, Christopher K. Bourke, and Mayor Fred J. Ledesma

NOES, Councilmembers:

ABSTAIN, Councilmembers:

ABSENT, Councilmembers:

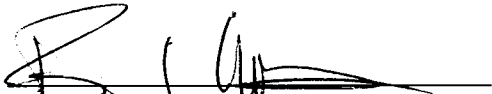

FRED J. LEDESMA, Mayor

ATTEST:



DONALD T. WILCOX, Interim City Clerk



Yamabe & Horn Engineering, Inc.

CIVIL ENGINEERS • LAND SURVEYORS

Exhibit - A

CC Reso. 5240

TASK ORDER FOR ENGINEERING SERVICES

Task Order No. 101

1. Pursuant to the Non Exclusive Consulting Service Agreement for engineering services dated November 8, 2012 and agreement extension dated September 7, 2016 extending the agreement under the same terms and conditions to November 5, 2018 ("Agreement"), between the City of Soledad and Yamabe & Horn Engineering, Inc. ("Engineer"), City hereby requests that Engineer provide engineering services for the following Project: **City of Soledad Front and East Street Intersection Traffic Signal.**

2. Engineer shall provide the following engineering services for the Project: See Attached proposal.

3. Engineer's services for the project are to commence on October 7, 2016, with anticipated completion by September 30, 2017.

4. Engineer shall be compensated for its services for the project as follows: **Per Approved Fee Schedule, Time and Material (T&M), Not to Exceed \$58,800.**

| | | |
|---------|-------------------------------------|----------|
| Task 1: | Field Review | \$1,000 |
| Task 2: | Utility Coordination..... | \$1,500 |
| Task 3: | Design and Preparation of PS&E..... | \$32,000 |
| Task 4: | Bid Support..... | \$1,500 |
| Task 5: | Construction Management..... | \$22,800 |

City and Engineer agree to the terms and conditions of this Task Order, and upon execution of this Task Order by both parties, this Task Order shall be approved, subject to all terms and conditions contained herein and in the Agreement, and this Task Order shall be appended to and become a part of the Agreement.

Yamabe & Horn, Engineering Inc.

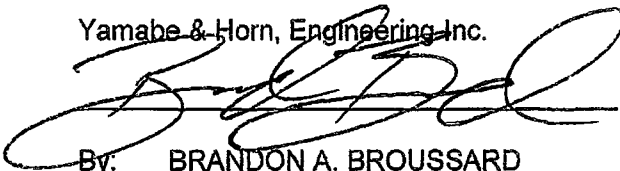
By: BRANDON A. BROUSSARD

Date: 09/22/16

City of Soledad

By: DONALD T. WILCOX, ACTING CITY MANAGER

Date: 11/03/2016

Date: 11/03/2016

Reso # 5240



Yamabe & Horn Engineering, Inc.

CIVIL ENGINEERS • LAND SURVEYORS

September 22, 2016

Donald T. Wilcox, P.E.
Public Works Director
CITY OF SOLEDAD
248 Main Street
Soledad, CA 93960

**Subject: Proposal for Professional Engineering Services for
City of Soledad Front and East Street Intersection Traffic Signal**

Dear Mr. Wilcox,

Pursuant to your request, we are pleased to submit this proposal for the subject project. Yamabe & Horn will perform the following task:

Task 1: Field Review.....\$1,000

This task will commence with kick off meeting with City staff, followed with field visit and investigation, which will include visual pavement evaluation, signing and striping analysis and ADA compliance assessment.

Task 2: Utility Coordination\$1,500

Yamabe & Horn will identify all existing underground and overhead utilities to be relocated, adjusted, removed, or modified to accommodate the project design. It is paramount to coordinate with PG&E right away considering the amount of time it will take to request a service connection design.

Task 3: Design and Preparation of PS&E.....\$32,000

Yamabe & Horn will commence the design and preparation of improvement plans, technical specifications and engineer's estimate for the proposed project. This includes running truck turning templates at the intersection. A preliminary layout has been attached for reference.

Construction Documents would be submitted for City review at the following milestones:

- a. **65%** - Improvement Plan package will include construction details, plan & profile sheets (if any), and traffic signal plan and draft project technical specifications. An engineer's estimated construction cost will also be provided. The plan shall include existing and proposed striping for each leg of the intersection to conform to current standards.
- b. **95%** - A biddable set of Plans, Specifications, and Estimate (PS&E) package will be submitted with all necessary contract information basically complete and accurate. Any required final minor modifications

C:\Users\rabbon\Desktop\2016-09-20 - Proposal & Task Order No. 101 - Front-East Street Signal Design.docx

2985 North Burl Ave., Suite 101 • Fresno, CA 93727 • P: 559.244.3123 • F: 559.244.3120 • yandhengr.com

"A committed team providing high quality engineering services for our clients and community."



Yamabe & Horn Engineering, Inc.

CIVIL ENGINEERS • LAND SURVEYORS

to plans could be worked out at this time prior to bid advertisement.
PG&E Rule 16 will also be included in design and bid package.

- c. 100% - Final PS&E package will be submitted for approval, signatures and reproduction by City for bid advertisement. The final products shall include timing sheet for the traffic signals at all proposed intersections.

Task 4: Project Bidding\$1,500
 Yamabe & Horn will provide support during bidding period, such as attending pre-bid conference, preparing addendum(s) if needed, and attending bid opening.

Task 5: Construction Management\$22,800
 Full turn-key construction management services before and during construction include general contract administration, attend the pre-construction conference, review submittals and shop drawings from Contractor, construction inspection, technical support, progress payment and contract change order(s) administration.

The tasks as specified above will be performed on a Time and Material (T&M) basis, based on the agreed Fee Schedule, not to exceed \$58,800. We will let the City know and submit subsequent expansion letter if additional fee is needed to perform work as described above or beyond.

Regards,

Ryan Rabbon, PE
Senior Civil Engineer

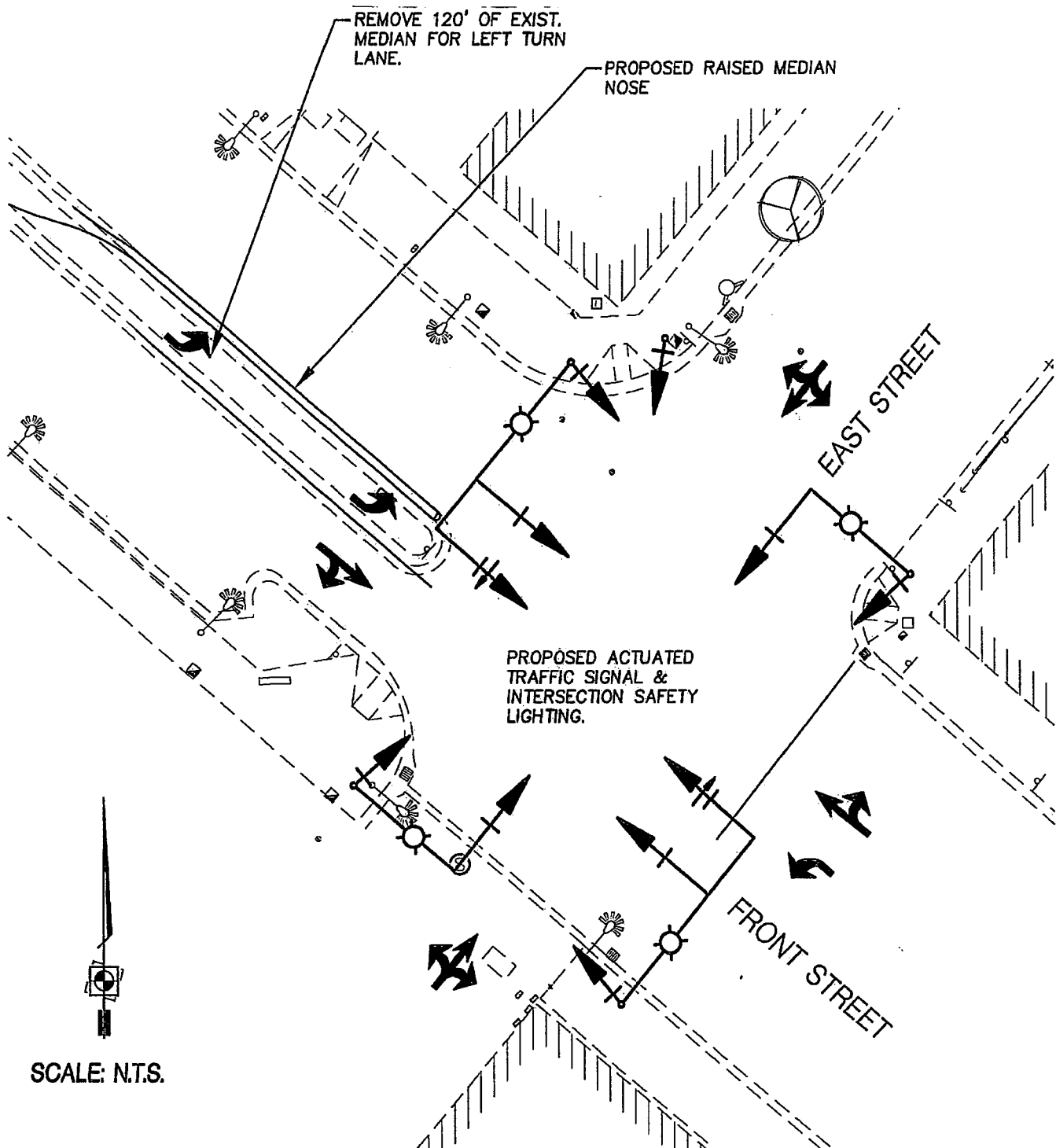

FRONT STREET & EAST STREET
PROPOSED TRAFFIC SIGNAL PROJECT
CONCEPTUAL EXHIBIT



**YAMABE & HORN
ENGINEERING, INC.**

745 FRONT STREET
SOLEDAD, CA 93980

TEL (831) 275-0030
FAX (559) 244-3120